

Pos. no.	KEPES Part no.	Description	Recommended Quantity
1	930300	Drive Fold Roller, 13 bands	1
2	930301	Fold Roller, 13 bands	2
3	930302	Fold Roller, 14 bands	3
4	930043	Segmented Glue Roller	As Needed
5	860354	Segmented Glue Nose for Fold Plate	
6	690005	Springs, extension	8
7	200114	Roller Bearing	2 per roller
8	612058	Pivot Bushings	14
9	730055	Pivot bolts	10
10	690040	Spring - compression	4
11	600502	Grease Cannister	2
12	410090	Infeed Guide	1
13	410066	Infeed Belt	1
14	790500	Suction Wheel	1

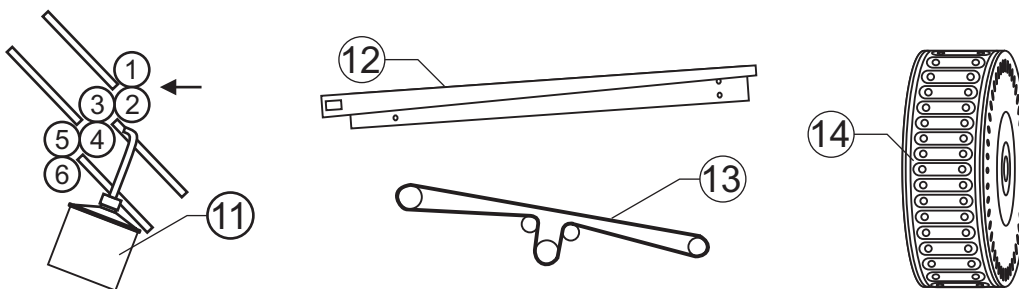

Synthetic Material Choices for Your Rollers



Rubber

Wear-resistant, able to rejuvenate



Foam

For aqueous coatings



Urethane

Durable, chemical resistant

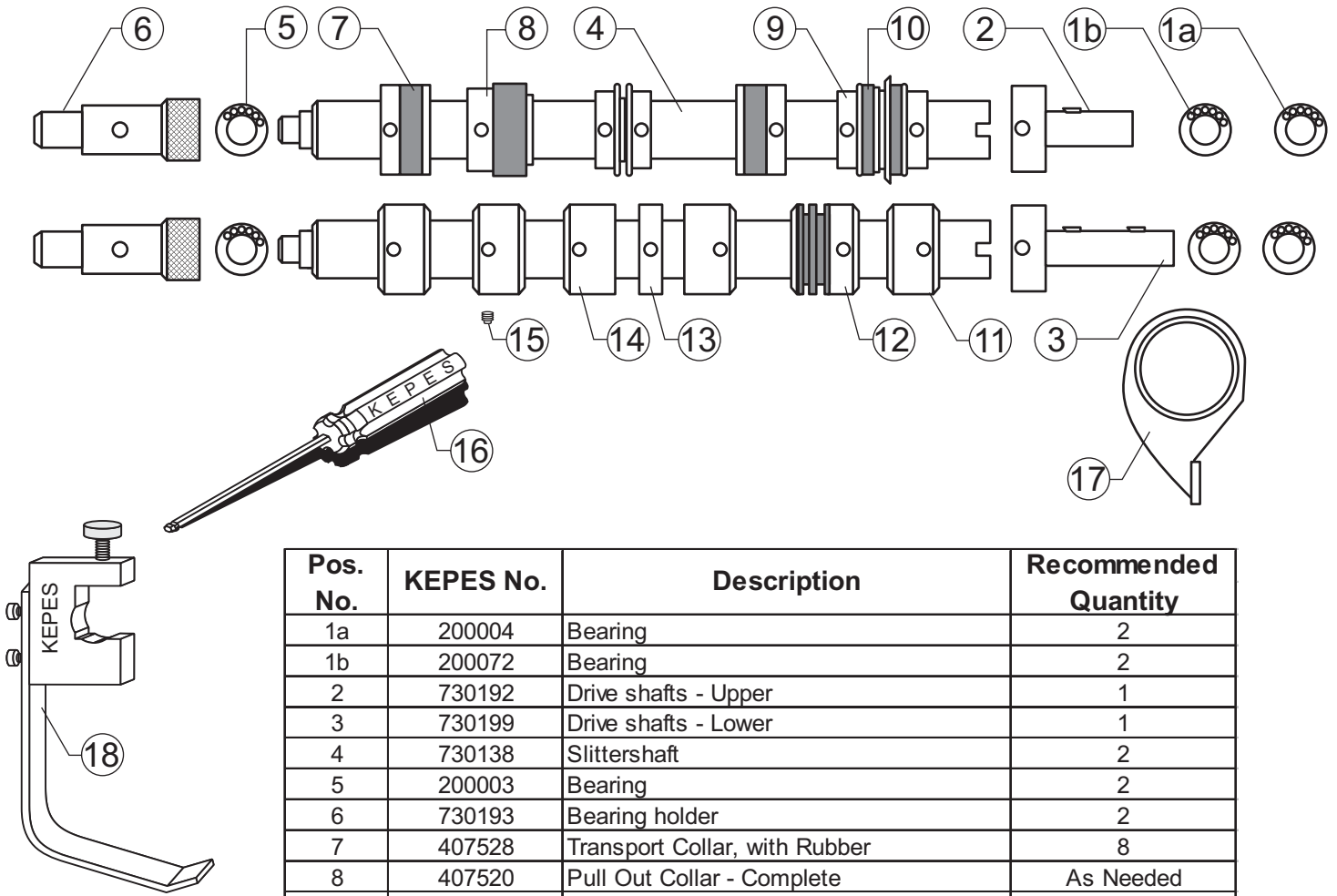

Pos. No.	KEPES No.	Description	Recommended Quantity
1a	200004	Bearing	2
1b	200072	Bearing	2
2	730192	Drive shafts - Upper	1
3	730199	Drive shafts - Lower	1
4	730138	Slittershaft	2
5	200003	Bearing	2
6	730193	Bearing holder	2
7	407528	Transport Collar, with Rubber	8
8	407520	Pull Out Collar - Complete	As Needed
8	407101	Pull Out Collar - Tire Only	As Needed
9	407500	Blade holder, standard w/3 - 1/8" spacers (edge trim ring not included)	1
10	400023	Edge trim ring only	As Needed
11	407529	Transport Collar, Steel	8
12	400042	Female score collar	As Needed
13	407607	14mm wide die block, double sided	As Needed
14	407539	Die block, standard, single sided	2
15	808015	Set screw, brass tip	As Needed
16	807010	4mm Pin wrench	1
17	409152	Bleed-out stripper	1
18	409224	Perforation stripper	1

Helpful Hints - While installing your rollers , be sure to check:

- Fold plate and deflector settings
- “Zero” the roller tension settings
- Check drive belts and pulleys for wear
- Inspect in-feed guide and belt for wear
- Clean or replace air pump filters (and vanes if applicable)
- Inspect electrical connections between units
- Inspect and clean the suction valve and wheel
- Check transport collars for wear, recover or replace if needed

For instruction on how to check these items
or if you have any other questions, call 262-652-7889