

Pos. no.	KEPES Part no.	Folder type		Description	Recommended Quantity
		T	B		
1	930252	78	30	Fold Roller, 21 bands	3
2	930251	78	30	Fold Roller, 22 bands	3
3	930600	78	30	Segmented Glue Roller	
4	860118	78	30	Segmented Glue Nose for Fold Plate	
1	930180	66	26	Fold Roller, 17 bands	3
2	930181	66	26	Fold Roller, 18 bands	3
3	930598	66	26	Segmented Glue Roller	
4	860116	66	26	Segmented Glue Nose for Fold Plate	
1	930118	56	22	Fold Roller, 15 bands	3
2	930119	56	22	Fold Roller, 16 bands	3
3	930599	56	22	Segmented Glue Roller	
4	860146	56	22	Segmented Glue Nose for Fold Plate	
5	690005			Springs, extension	8
6a	200067			Roller Bearing	6
6b	200071			Roller Bearing	6
7	612058			Pivot Bushings	12
8	730055			Pivot bolts	10
9	690040			Springs, compression	4
10	600502			Grease Cannister	2
11	Please Call			Infeed Guide	1
12	Please Call			Infeed Belt	1
13	880040/600562			Suction Wheel - 3 hole/2 hole	1

3-piece

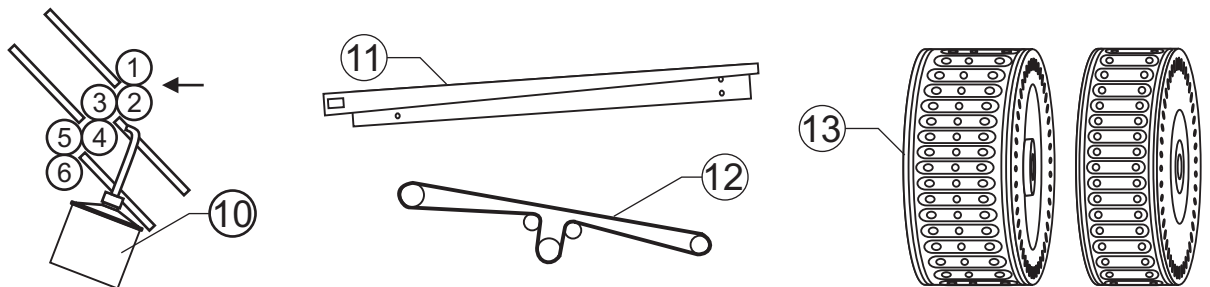

### Synthetic Material Choices for Your Rollers



#### Rubber

Wear-resistant, able to rejuvenate



#### Foam

For aqueous coatings



#### Urethane

Durable, chemical resistant

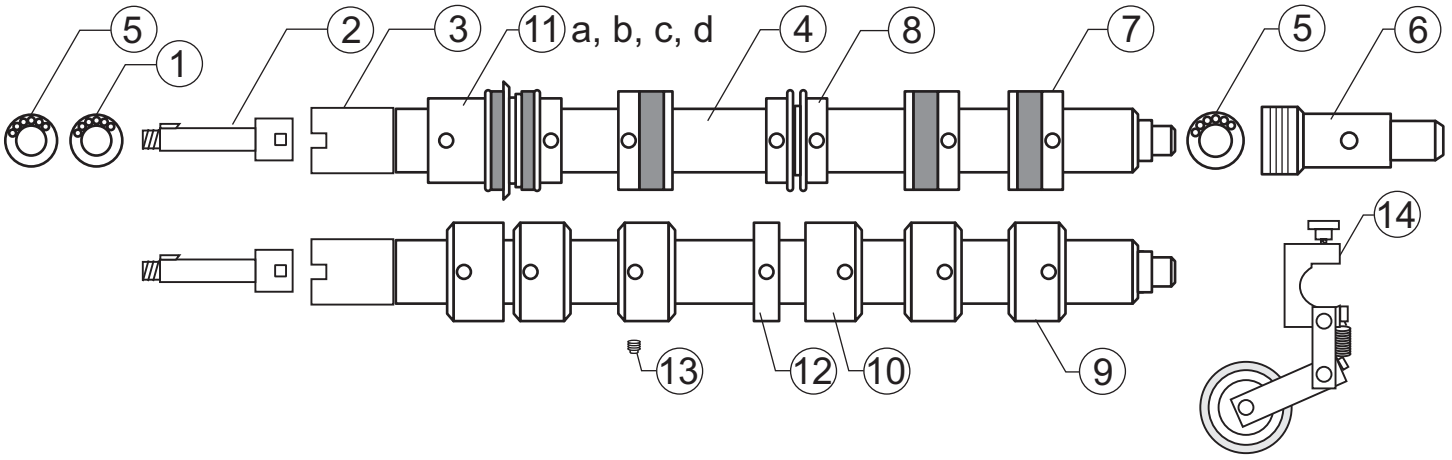

Pos. No.	KEPES No.	Folder type		Description	Recommended Quantity
		T	B		
1	200072			Bearing, drive side	4
2	750014/c			Stub shaft	2
3	600318			Slittershaft, drive coupling only	2
4	930144	78	30	Slittershaft, 78	2
4	930068	66	26	Slittershaft, 66	2
4	930008	56	22	Slittershaft, 56	2
5	200004			Bearing, idler side	2
6	730109			Bearing holder	2
7	407535			Transport Collar, with Rubber	
8	407502			Blade holder, standard	
9	407532			Transport Collar, Steel	
10	407538			Counter knife, standard, single sided	
11a	407605			Blade holder, wide	
11b	790094			Edge trim ring	
11c	407510			1/16" Blade spacer standard OD	
11c	407511			1/8" Blade spacer standard OD	
11c	407512			1/4" Blade spacer standard OD	
11d	612063			1mm Blade spacer, small OD	
11d	612069			.5mm Blade spacer, small OD	
12	407608			Counter knife, narrow, double sided	
13	808015			Set screw, brass tip	
14	411222			Ejector wheel, cpl	

***Helpful Hints - While installing your rollers , be sure to check:***

- Fold plate and deflector settings
- “Zero” the roller tension settings
- Check drive belts and pulleys for wear
- Inspect in-feed guide and belt for wear
- Clean or replace air pump filters (and vanes if applicable)
- Inspect electrical connections between units
- Inspect and clean the suction valve and wheel
- Check transport collars for wear, recover or replace if needed

For instruction on how to check these items  
or if you have any other questions, call 262-652-7889