

Pos.	KEPES #	Main Drive Roller	Qty
1	600843	Cap	1
2	600504	2 pc thrust spacer	2
3	612094	Spacer	1
4	612181	Spacer	1
5	930631	Drive roller double handwheel, 13 bands	1 - 0
5	930037	Drive roller single handwheel, 13 bands	1 - 0
6	612026	Thrust Washer - Thin	1
7	200087	Bearing	1
8	612102	Thrust Washer - Thick	1
9	811136	Broached washer	6
10	811455	Washer w/tab on OD	6
11	930035	Idler roller 13 bands (B)	2 - 3
11	930036	Idler roller 12 bands (F)	3 - 4
12	690005	Spring	10
13	600733	Hanger pin	10
14	690040	Spring - Slittershaft	2

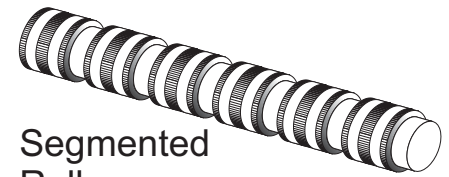

Segmented
Rollers
for Gluing 930615 Idler
930616 Drive

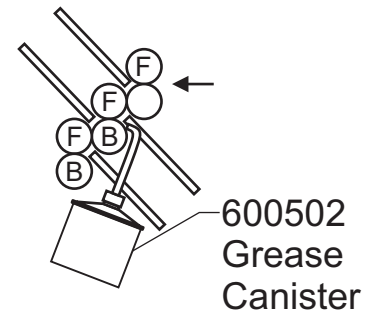

410052 Belt

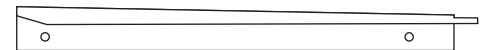

600712 Infeed Guide

*We have provided the common replacement parts needed when replacing or remanufacturing your rollers on this page.
For a complete parts book for your T36
www.kepes.com
262-652-7889*

Synthetic Material Choices for Your Rollers



Rubber

Wear-resistant,
able to rejuvenate



Foam

For aqueous coatings



Urethane

Durable,
chemical resistant

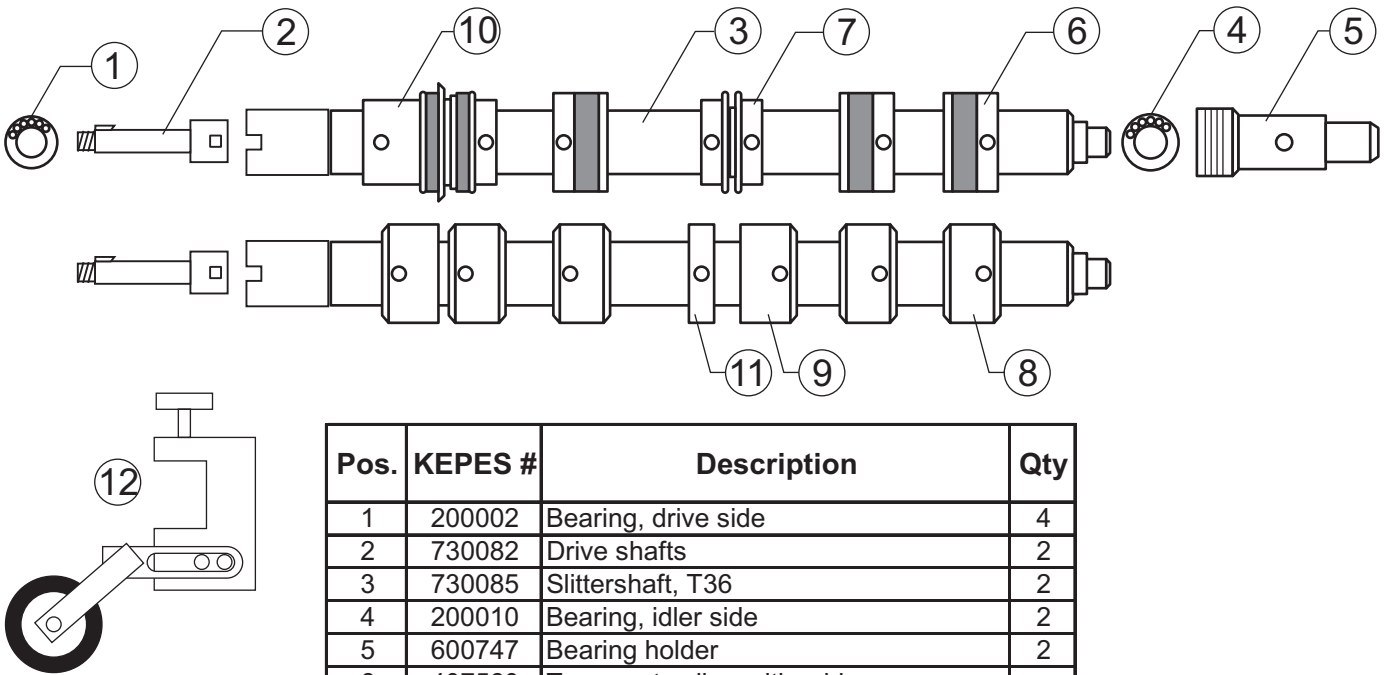

Pos.	KEPES #	Description	Qty
1	200002	Bearing, drive side	4
2	730082	Drive shafts	2
3	730085	Slittershaft, T36	2
4	200010	Bearing, idler side	2
5	600747	Bearing holder	2
6	407560	Transport collar, with rubber	
7	407609	Blade holder, narrow	
8	407562	Transport collar, steel	
9	407561	Counter knife, standard, single sided	
10	407564	Center trim, complete	
11	407606	Counter knife, narrow, double sided	
12	600722	Ejector wheel, complete	

For perforators, slitters, and scores;

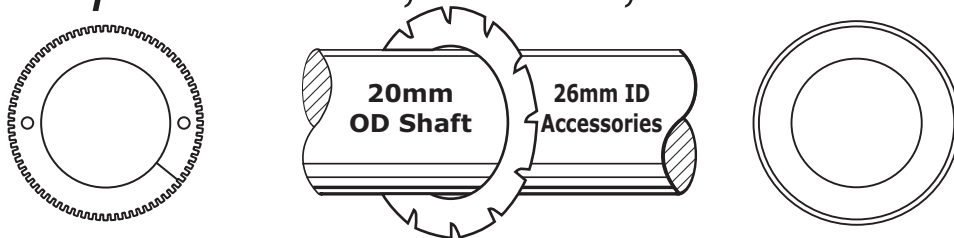

kepesparts.com

Helpful Hints - While installing your rollers, be sure to check:

- Fold plate and deflector settings
- “Zero” the roller tension settings
- Check drive belts and pulleys for wear
- Inspect in-feed guide and belt for wear
- Clean or replace air pump filters (and vanes if applicable)
- Inspect electrical connections between units
- Inspect and clean the suction valve and wheel
- Check transport collars for wear, recover or replace if needed

For instruction on how to check these items
or if you have any other questions, call 262-652-7889